



Porpoise Tap

Chilled • Hot • Filtered



**Robust
and ligature-
resistant tap for
mental health
facilities**

trial it, love it, keep it!

Request your no obligation 10 day trial

Call **01392 877 172** Email **hello@thirstywork.com**

www.thirstywork.com/free-trial



hydrateconsciously!
We're committed to reducing plastic waste

Porpoise Tap

Surface-mounted ligature-resistant water tap



KEY FEATURES

- High capacity output
- Chilled and hot water options
- Chilled temperature: 2°C to 11°C
- Designed to minimise the risk of misuse and self-harm
- Shallow, safe ligature-resistant design
- Anti-scald hot temperature: 69°C
- Install over sink
- Compact under-counter unit
- Intelligent hot tap technology
- Robust, vandal-proof qualities
- Powerful and energy-efficient
- Hygiene assurance
- Designed and built in the UK
- With advanced **pura** filtration

Prioritising safety and hygiene, the Porpoise ligature-resistant drinking water tap has been designed for modern mental health and vandalism-prone environments. It features anti-scald temperature settings to ensure patient, visitor and staff safety, whilst maintaining hot water dispense.

The design features a smooth, shallow profile with robust, vandal-proof qualities. When positioned at the edge of a sink or countertop this design leaves no room for ligature attachment, making it appropriate for vulnerable people to use unsupervised.

The inbuilt **pura** filter puts better-tasting water on tap, filtering out chlorine taste, odour and impurities.

COLOUR OPTIONS



Steel



Black

WATER OPTIONS



Chilled



Filtered



Hot

INSTALLATION OPTIONS



Over sink



Under-counter
unit

DIMENSIONS

Tap height:	68mm
Tap width:	124mm
Tap depth:	138mm

Call **01392 877 172** or email **hello@thirstywork.com** to build your water dispenser package

OUTPUT OPTIONS

The Porpoise is fed from an under-counter unit.

Porpoise Model	Chilled litres/hr	Hot litres/hr	Max power consumption	Water System	Under-counter unit dimensions (mm)
ProCore	50	16	1670W	Dry Chill®	W 320 x D 471 x H 400

Simple-fit ventilation base included

PRODUCT OPTIONS - Porpoise Tap System

Water options	L/hr	Black	Silver
Chilled and hot	50	743650	743655

TAP DIMENSIONS

Dimensions shown in mm

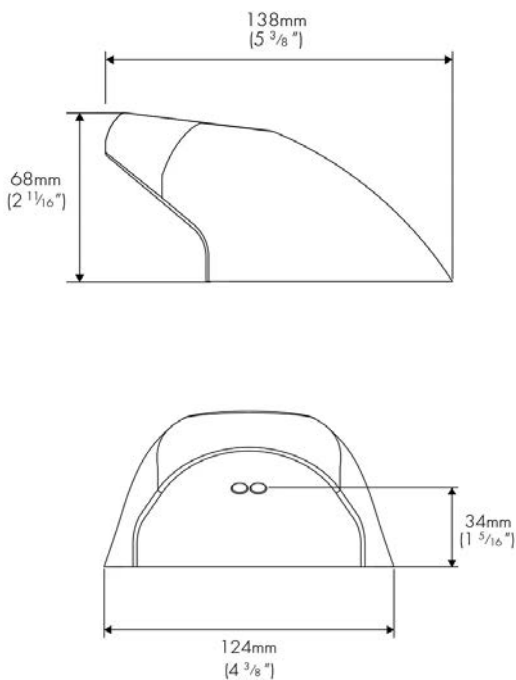

INSTALLATION REQUIREMENTS

The Porpoise Tap requires adequate worktop and cupboard space for installation. Please ensure that the following is available where the system is to be installed:

- ✓ **A potable mains water supply within 5 metres of unit installation location.**
- ✓ **A 240-volt electric socket within 1 metre of unit location.**
- ✓ **Worktops are clear and in a finished state.**
- ✓ **Any cupboard construction to house the equipment is complete** (if applicable).
- ✓ Worktop cutting template available to order.
- ✓ All of the above can be confirmed in your site survey.

Identify a suitable location for the ProCore unit. It should be positioned within 1.0m of the faucet, and within 2.0m of suitable services connections. Ensure to allow enough space for the Simple-fit Vent Kit which must be installed with the unit.

AVAILABLE ACCESSORIES



Recyclable Paper Cups

- 7oz recyclable paper cups
- 4oz paper cones



Thirsty Work Water Bottles

Thirsty Work 500ml reusable stainless steel water bottles. 67mm x 270mm high.



Bespoke Printed Water Bottles

Add your own company logo to our 500ml reusable stainless steel water bottles. Available in a range of colours.



Under-counter Unit

Our Porpoise Tap must be accompanied by our under-counter water chiller. It is compact, low maintenance and easy to install out of sight.



Secure Anti-ligature Resistant Stainless Steel Sink Cabinet

Choose front panel or doors. 1000mm x 650mm x 900mm. Ask about smaller sizes.

trial it, love it, keep it!

Request your no obligation 10 day trial

Call **01392 877 172** Email **hello@thirstywork.com**

www.thirstywork.com/free-trial