



Oasis OutdoorFS Bottle Filler

Mains Fed • Floor Mounted • Ambient



trial it, love it, keep it!

Request your no obligation 10 day trial

Call **01392 877 172** Email **hello@thirstywork.com**

www.thirstywork.com/free-trial

Oasis OutdoorFS

Mains fed, floor mounted, outdoor bottle filler



COLOUR OPTIONS (may vary on final product)



Forest
green



White

WATER OPTIONS



Ambient

INSTALLATION OPTIONS



Floor-standing

KEY FEATURES

- High volume water bottle filler
- Choose from 2 colour options
- Floor mounted
- Suitable for outdoor public environments
- Heavy duty, vandal-resistant
- Non-filtered, non-refrigerated model
- Manual push-button activation
- 316 stainless steel
- No electricity required

The Oasis OutdoorFS pedestal bottle filler is ideal for outdoor installation in busy environments. It has been designed with an open-sided alcove for easy access and vandal-resistant, corrosion-resistant cabinetry to ensure durability in any environment.

The Oasis OutdoorFS Bottle Filler is a sustainable hydration solution that promotes eco-friendly habits and reduces plastic waste and litter, refilling standard 500ml drinks bottle fast. It requires no electricity, for easy installation and maximum flexibility in placement.

DIMENSIONS

Height:	1600mm
Width:	355.6mm
Depth:	355.6mm
Dispense height:	380mm

UNIT DIMENSIONS

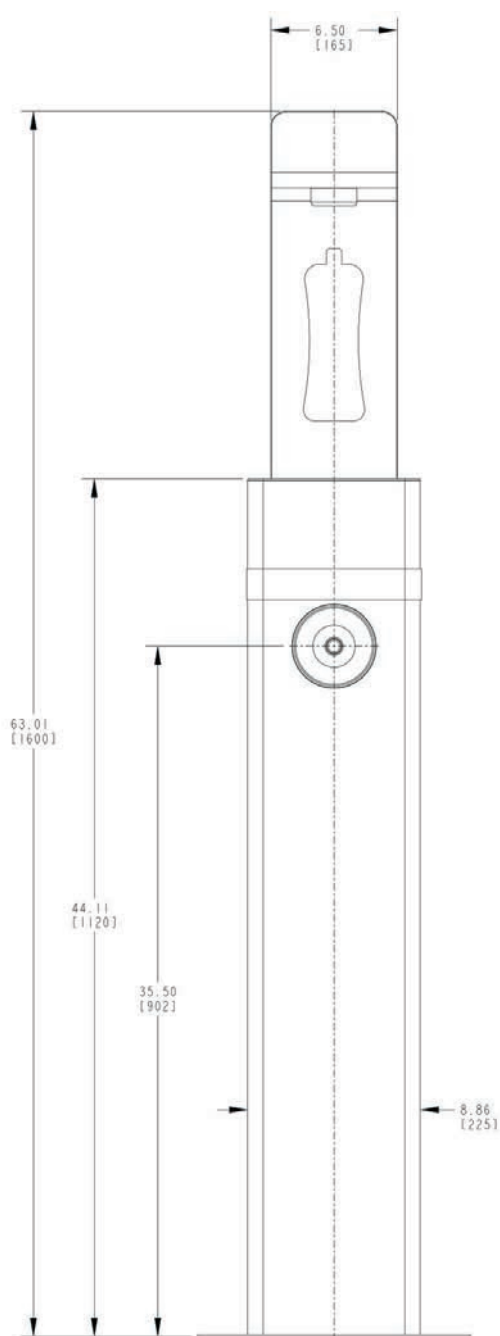

INSTALLATION REQUIREMENTS

The Oasis OutdoorFS requires adequate floor space for installation. Please ensure that the following is available where the unit is to be installed:

- ✓ **Minimum installation floor space:**
W 440mm x D 620mm
- ✓ **Minimum height clearance requirement:** H 530mm.
- ✓ **A potable mains water supply within 5 metres of unit installation location.**
- ✓ All of the above can be confirmed in your site survey.

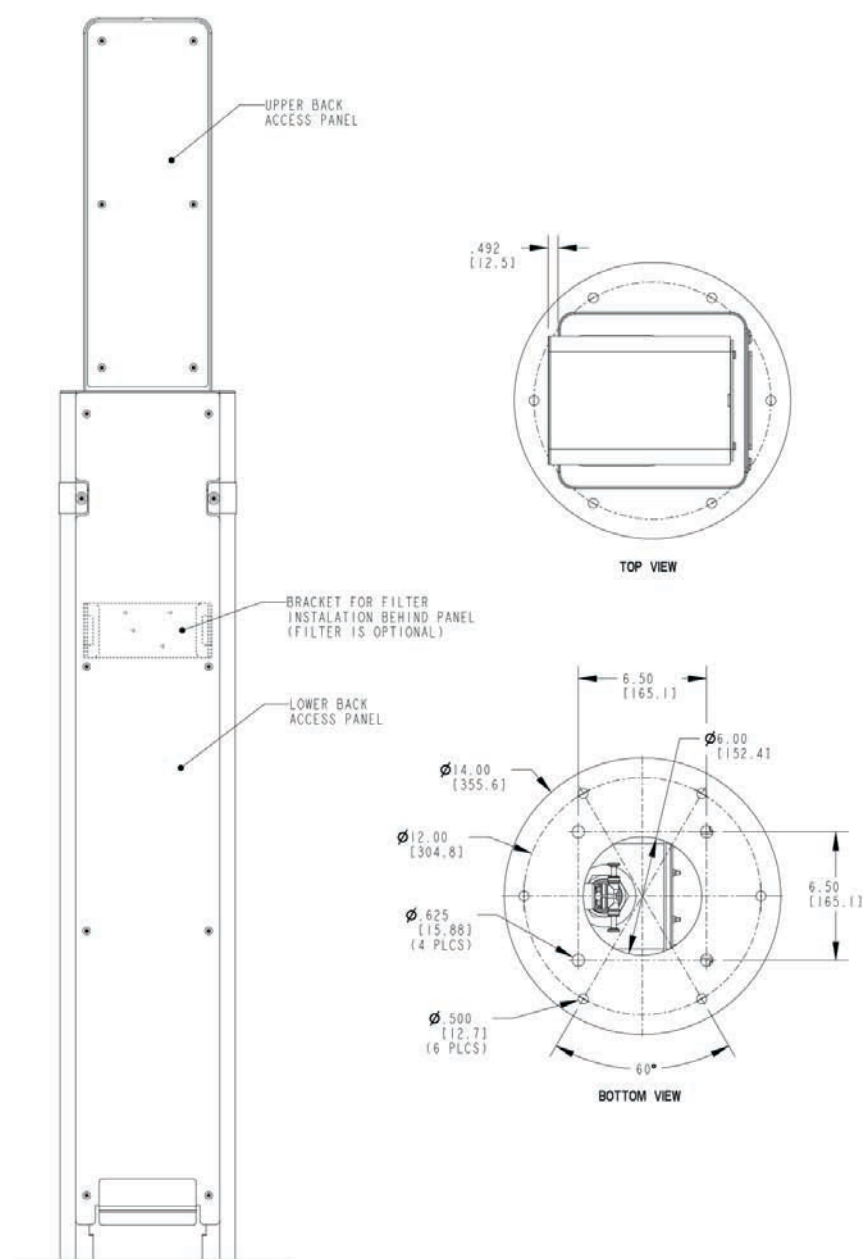

Information correct at time of printing, please check manufacturer website for latest installation information.

Call **01392 877 172** or email **hello@thirstywork.com** to build your drinking water system

FULL SPECIFICATION Floor-mounted, Oasis OutdoorFS Water Bottle Filler

Rated input	N/A
Throughput litres per hour	Dependant on mains water pressure
Dimensions	355.6mm (W) x 355.6mm (D) x 1600mm (H)
	Dispense height: 380mm

AVAILABLE ACCESSORIES



Recyclable Paper Cups

- 7oz recyclable paper cups
- 4oz paper cones



Thirsty Work Water Bottles

Thirsty Work 500ml reusable stainless steel water bottles. 67mm x 270mm high.



Bespoke Printed Water Bottles

Add your own company logo to our 500ml reusable stainless steel water bottles. Available in a range of colours.

trial it, love it, keep it!

Request your no obligation 10 day trial

Call **01392 877 172** Email **hello@thirstywork.com**

www.thirstywork.com/free-trial