



Oasis OutdoorFS Bottle Filler

Mains Fed • Floor Mounted • Ambient



trial it, love it, keep it!

Request your no obligation 10 day trial

Call **01392 877 172** Email **hello@thirstywork.com**

www.thirstywork.com/free-trial

Oasis OutdoorFS

Mains fed, floor mounted, outdoor bottle filler



COLOUR OPTIONS (may vary on final product)



Forest green



White

WATER OPTIONS



Ambient

INSTALLATION OPTIONS



Floor-standing

KEY FEATURES

- High volume water bottle filler
- Choose from 2 colour options
- Floor mounted
- Suitable for outdoor public environments
- Heavy duty, vandal-resistant
- Non-filtered, non-refrigerated model
- Manual push-button activation
- 316 stainless steel
- No electricity required

The Oasis OutdoorFS pedestal bottle filler is ideal for outdoor installation in busy environments. It has been designed with an open-sided alcove for easy access and vandal-resistant, corrosion-resistant cabinetry to ensure durability in any environment.

The Oasis OutdoorFS Bottle Filler is a sustainable hydration solution that promotes eco-friendly habits and reduces plastic waste and litter, refilling standard 500ml drinks bottle fast. It requires no electricity, for easy installation and maximum flexibility in placement.

DIMENSIONS

Height:	1600mm
Width:	355.6mm
Depth:	355.6mm
Dispense height:	380mm

UNIT DIMENSIONS

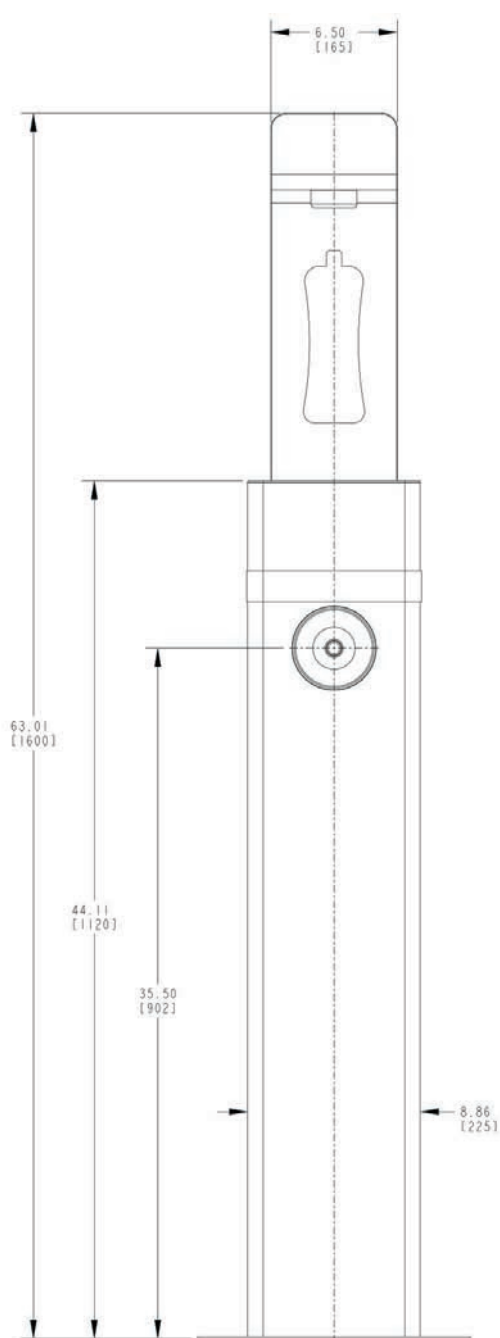

INSTALLATION REQUIREMENTS

The Oasis OutdoorFS requires adequate floor space for installation. Please ensure that the following is available where the unit is to be installed:

- ✓ **Minimum installation floor space:**
W 440mm x D 620mm
- ✓ **Minimum height clearance requirement:** H 530mm.
- ✓ **A potable mains water supply within 5 metres of unit installation location.**
- ✓ All of the above can be confirmed in your site survey.

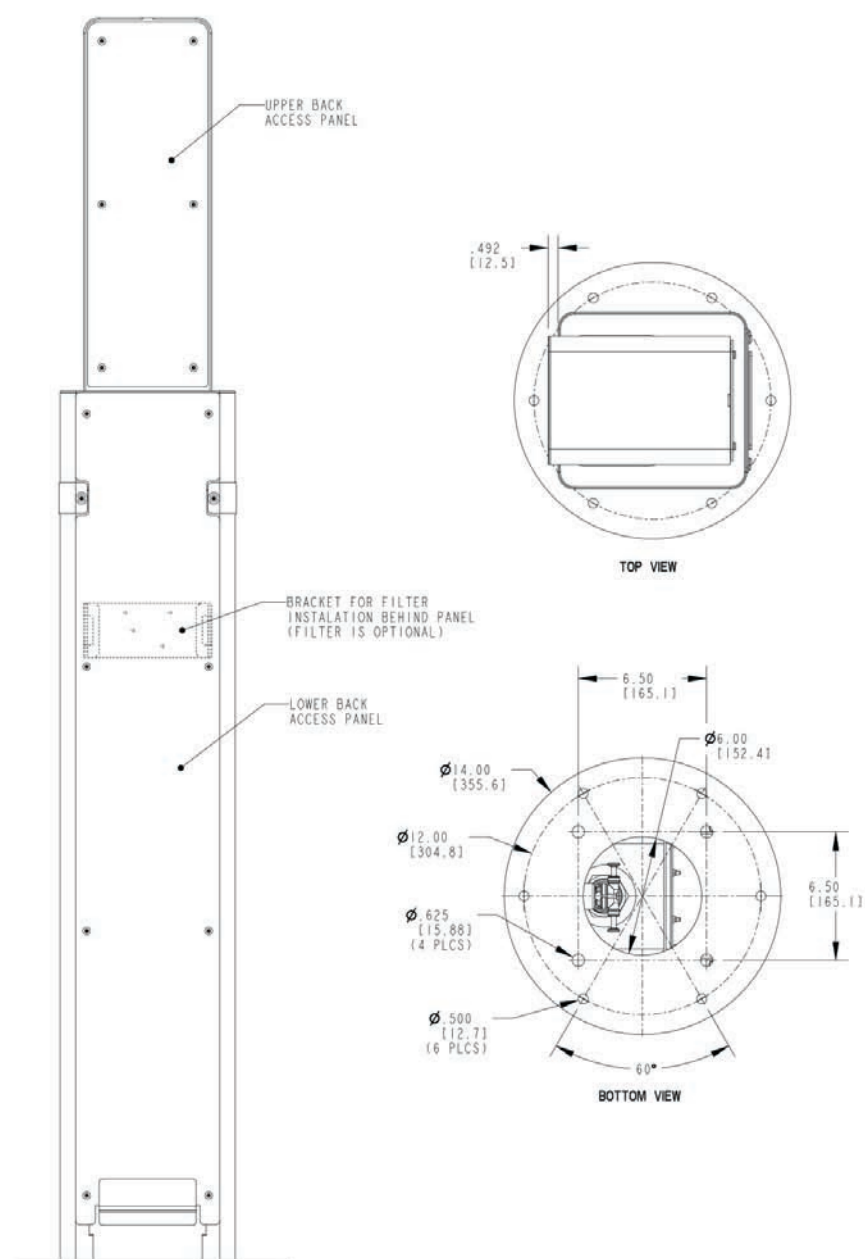

Information correct at time of printing, please check manufacturer website for latest installation information.

Call **01392 877 172** or email **hello@thirstywork.com** to build your drinking water system

FULL SPECIFICATION Floor-mounted, Oasis OutdoorFS Water Bottle Filler

Rated input	N/A
Throughput litres per hour	Dependant on mains water pressure
Dimensions	355.6mm (W) x 355.6mm (D) x 1600mm (H)
	Dispense height: 380mm

INSTALLATION REQUIREMENTS

The Oasis OutdoorFS requires adequate floor space for installation. Please ensure that the following is available where the system is to be installed. All of the below can be confirmed in your site survey:

- ✓ **A level floor pad of concrete or similar that can support 31.2 kg. Minimum dimensions 400mm x 400mm.**
- ✓ **A potable water supply in 15mm pipe directly through the centre of the floor pad.**
- ✓ **A waste pipe with a minimum size of 32mm along side the water supply pipe.**
- ✓ **A Direct Bury fountain adapter is an accessory available. It provides a safe housing for the internal service pipes and a template within your prepared concrete pad for secure connection. Optional extra, please request at time of order.**

AVAILABLE ACCESSORIES



Recyclable Paper Cups

- 7oz recyclable paper cups
- 4oz paper cones



Thirsty Work Water Bottles

Thirsty Work 500ml reusable stainless steel water bottles. 67mm x 270mm high.



Bespoke Printed Water Bottles

Add your own company logo to our 500ml reusable stainless steel water bottles. Available in a range of colours.



Request your no obligation 10 day trial

Call **01392 877 172** Email **hello@thirstywork.com**

www.thirstywork.com/free-trial